

# Cherrywood Lane Water Main Replacement West Chester, OH

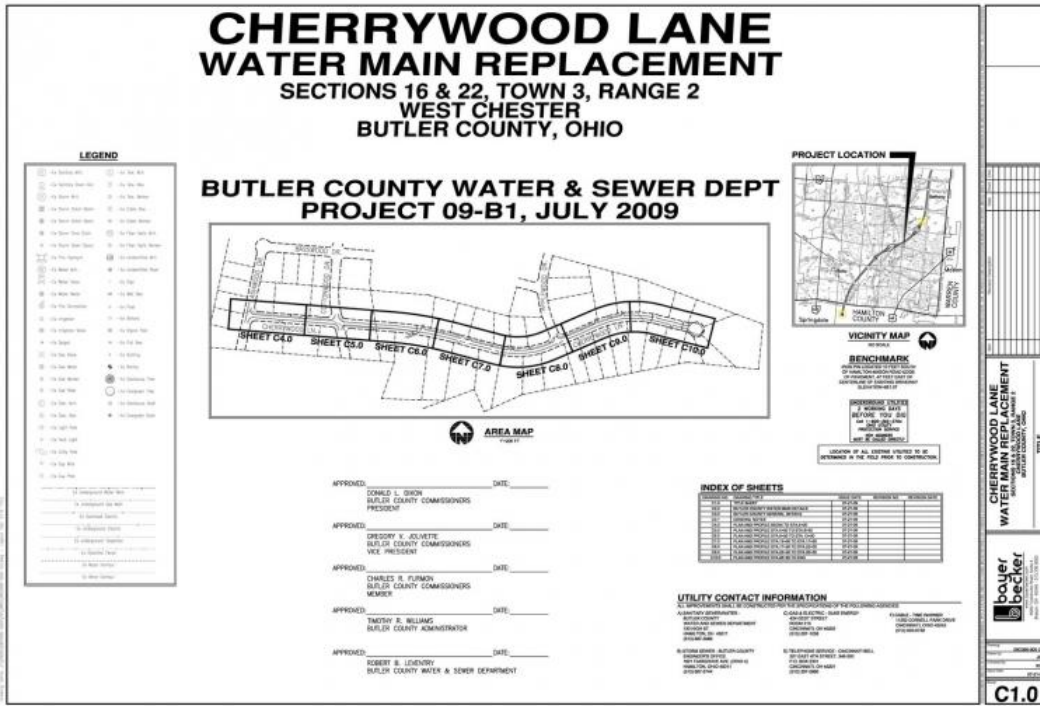

## Project Stats

<b>Client:</b>	Butler County Water and Sewer Department
<b>Location:</b>	West Chester, OH
<b>Year:</b>	2009
<b>Market:</b>	<a href="#">Water Supply Infrastructure</a>
<b>Project Size:</b>	3198.00 Linear Feet - Pipe

## Services Provided:

### SURVEYING SERVICES

Right-of-way Surveys & Drawings  
Topographic Surveys

### CIVIL ENGINEERING SERVICES

Bidding Assistance  
Construction Administration  
Water Supply Infrastructure

### LANDSCAPE ARCHITECTURE & PLANNING SERVICES

Contract Documents and Specifications

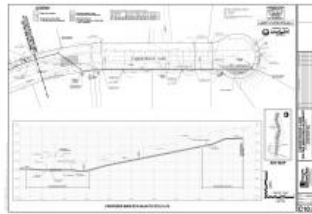
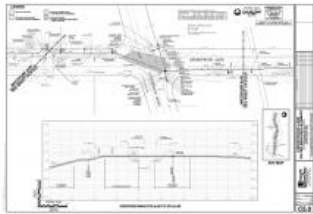

The existing 40 year old cast iron water main on Cherrywood Lane had become problematic for the County. The project featured both a replacement and upgrade to an existing 6" cast iron main. Frequent main breaks and service disruptions were common because of the main's age and material. Bayer Becker's design called for a new ductile iron 8" water main to replace the aging, problematic 6" cast iron. Bayer Becker's design for the Cherrywood Lane water main project allowed for the new main to connect to the existing system during construction, yet still remain isolated for testing and disinfection purposes.

The first step in the design process involved surveying the entire 3,000 linear foot project to create a base map and establish property and right of way limits. Bayer Becker worked with the County to establish a preliminary alignment before finalizing the plan. Open cut versus jack and bore locations were identified and all existing homes were reconnected to the new main. Once the new main was approved for use, the old main was disconnected and abandoned permanently.